

SOUTHRIDGE MEDICAL BUILDING

12541 FOSTER

Overland Park, Kansas 66213

est. 1879

KH

KESSINGER HUNTER
commercial real estate

OFFICE FOR LEASE | 1,573-9,773± RSF



Southridge Medical Building is located adjacent to Saint Luke's South Hospital in Overland Park, Kansas, providing immediate access to their services. The Saint Luke's South multi-specialty ambulatory surgery center located on the first floor of the building is available for all outpatient surgery services. It contains three operating rooms and one swing room. Its location is in the heart of South Johnson County and provides direct access to Metcalf & I-435, major arteries for patients and physicians alike. The building was completed in 2007, providing the latest medical technologies.

RENTABLE BUILDING AREA	57,844± RSF
BASE RENTAL RATE	\$21.00 PSF
LEASE TYPE	NNN

FOR MORE INFORMATION, PLEASE CONTACT:

Debbie Schulte, SIOR
Principal, Office Brokerage
(816) 936-8549
dschulte@kessingerhunter.com

KESSINGER HUNTER & COMPANY, LC
2600 Grand Boulevard, Suite 700
Kansas City, MO 64108
(816) 842-2690
kessingerhunter.com

BUILDING FACTS

BUILDING SIZE:	57,844 RSF
RENTAL RATE:	\$21.00, NNN
SPACE AVAILABLE:	Suite 200 - 1,573± RSF first generation office finish Suite 240 - 5,247± RSF Class A medical office finish Suite 260 - 8,200± RSF medical office finish
OPERATING COSTS:	The rental rate is net of operating costs for the property, including common area maintenance, taxes, insurance, utilities, janitorial, and building management.
MONUMENT SIGNAGE:	Tenant signage available.
LAST FINISHED SUITE:	Suite 200 has been finished in white box condition which includes sheetrock, ceiling lighting, and HVAC. The suite can be finished for medical or office use designed to suit in 45 days.
FLOORS:	Three
ELEVATORS:	Two
PARKING:	289 surface parking stalls
LOCATION:	Adjacent to Saint Luke's South Hospital at 125th & Metcalf
NEARBY AMENITIES:	Retail shopping includes Costco, Target, Kohl's, Best Buy, Bed Bath & Beyond, and much more. Restaurant services include major varieties from sandwiches to high quality dining nearby. Hotel services are multiple and provide upper quality business to child-friendly, all within blocks of the building.



Saint Luke's South Surgery Center is located on the first floor of the building. The Center contains three operating rooms and one swing room.



Floor Plan

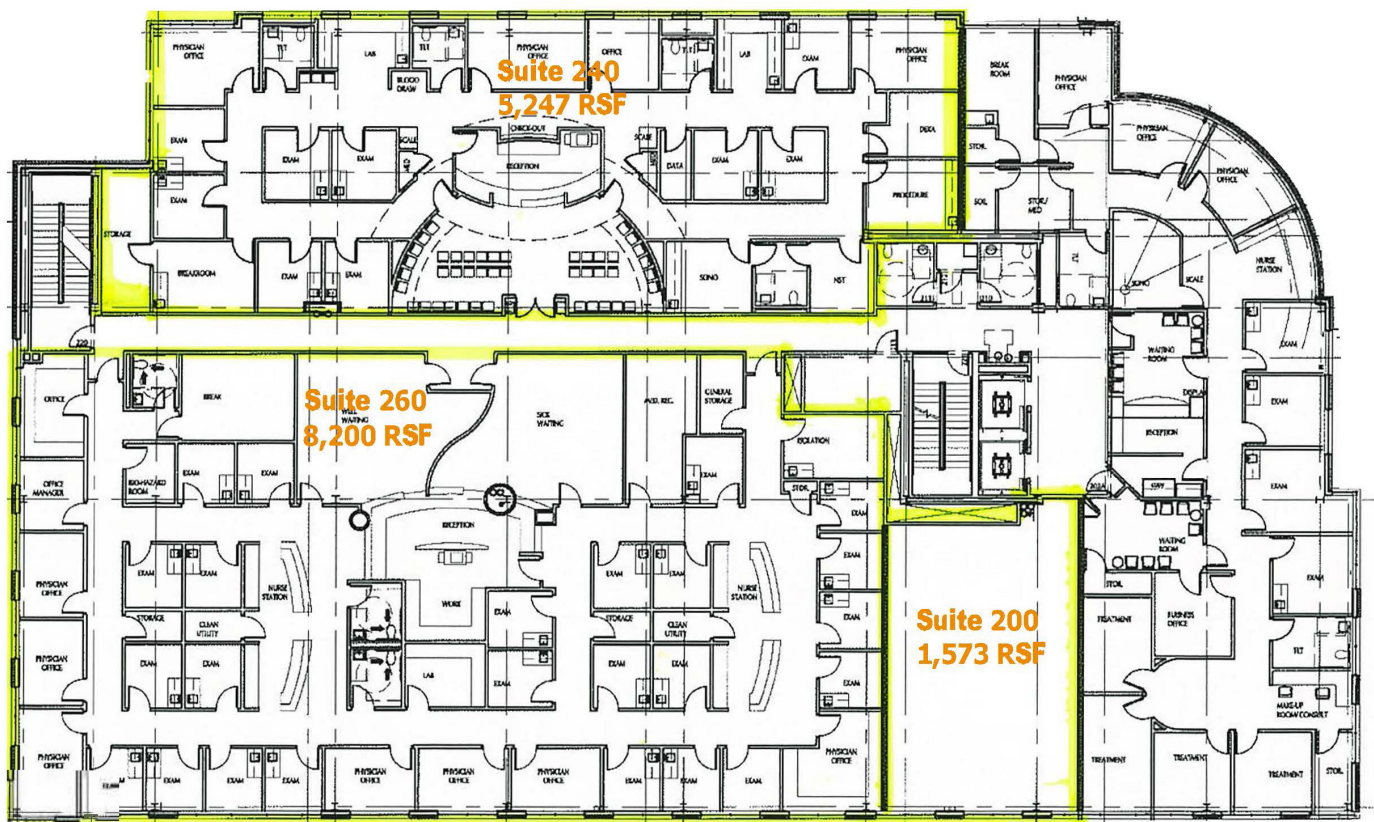

AERIAL

